

Safe-T-Cover aluminum enclosures offer the best protection for your waterworks equipment throughout every season.

Now, our rugged durability is matched by *rigid security*.



Introducing our exclusive **LOK-360** security system, available now for all 3/4" - 2" backflow assemblies.

Conventional locking devices like bent rods and padlocks are easily manipulated or cut.

LOK-360 reimagines enclosure security

We start with mounting internal brackets flush to the inner enclosure walls, providing added structural stability and protection to the enclosure.

A locking rod with flat washer passes through the brackets and is secured by a circular, puck-shaped lock on the other side.

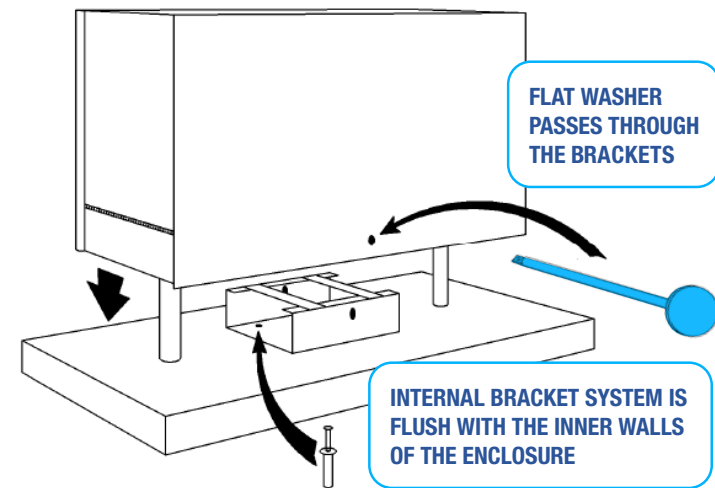

This puck lock on one side and flat washer on the opposite side are both flush to the enclosure, preventing would-be thieves or vandals with bolt cutters or hacksaws from breaking into your enclosure.

LOK-360's low-profile design is discrete,

so you can be assured that your equipment is as well protected from unauthorized persons as it is from any extreme weather.